

# Klacci®

life unlocked.



— **RL** Series

## Lever Trim

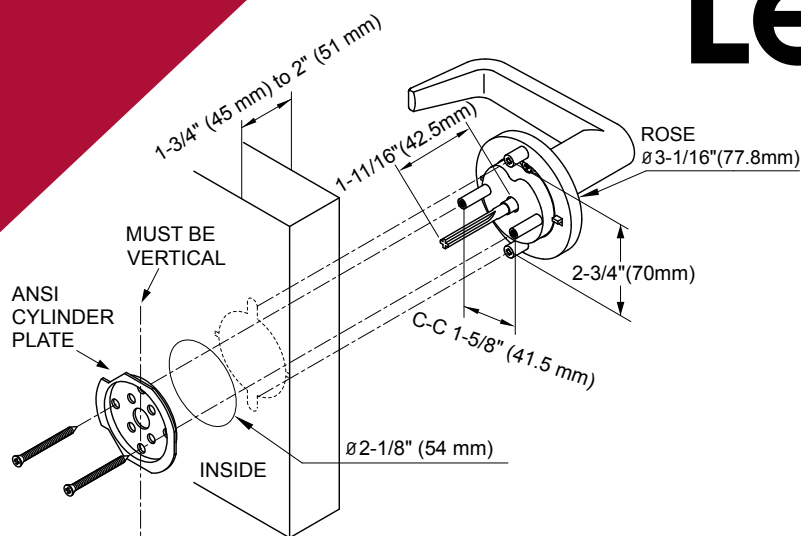

Exterior trim for panic exit device that installs or retrofits on cylindrical cut-out doors.

### Trim Options

D type (Standard)	Q type

<b>Applications</b>	<ul style="list-style-type: none"> <li>Heavy duty commercial, institutional, governmental buildings and other public accommodations or private entities.</li> </ul>
<b>Door Thickness</b>	<ul style="list-style-type: none"> <li>Standard 1-3/4\" (45 mm) to 2\" (51 mm) on wood or metal door.</li> </ul>
<b>Handing</b>	<ul style="list-style-type: none"> <li>Non-handed.</li> </ul>
<b>Trim</b>	<ul style="list-style-type: none"> <li>Solid zinc diecast levers, wrought brass roses, concealed screws.</li> </ul>
<b>Cylinder</b>	<ul style="list-style-type: none"> <li>6-pin "C" keyway standard, nickel silver keys. Also available with SFIC cylinder.</li> </ul>
<b>Spindle</b>	<ul style="list-style-type: none"> <li>Cross design (spindle length: 1-11/16\" (42.5 mm) for Entrance and Passage function, 1-9/16\" (39.6 mm) for Storeroom function).</li> <li>Flat design is available.</li> </ul>
<b>Lever Options</b>	<ul style="list-style-type: none"> <li>D type 5-3/8\" (136.5 mm) wide 2-1/4\" (57.1 mm) long.</li> <li>Q type 5-1/8\" (132 mm) wide 2-1/4\" (57.7 mm) long.</li> </ul>
<b>Functions</b>	<ul style="list-style-type: none"> <li>Entrance, Storeroom, Passage.</li> </ul>
<b>Finishes</b>	<ul style="list-style-type: none"> <li>605,606,612,613,625,626.</li> </ul>
<b>Thru-bolt</b>	<ul style="list-style-type: none"> <li>Forged material, center to center dimension: 1-5/8\" (41.5mm).</li> </ul>



www.klacci.com